



DIAMOND 2016

(SAFIR[®] post-processing tool)

New features



João Ferreira
Jean-Marc Franssen
Thomas Gernay



Organization of the graphical interface

- Some differences in the logic and arrangement

Configuration - the model entities can be drawn in the initial, in the displaced, or in both configurations

Model entities

Results - are plotted in one of the configurations

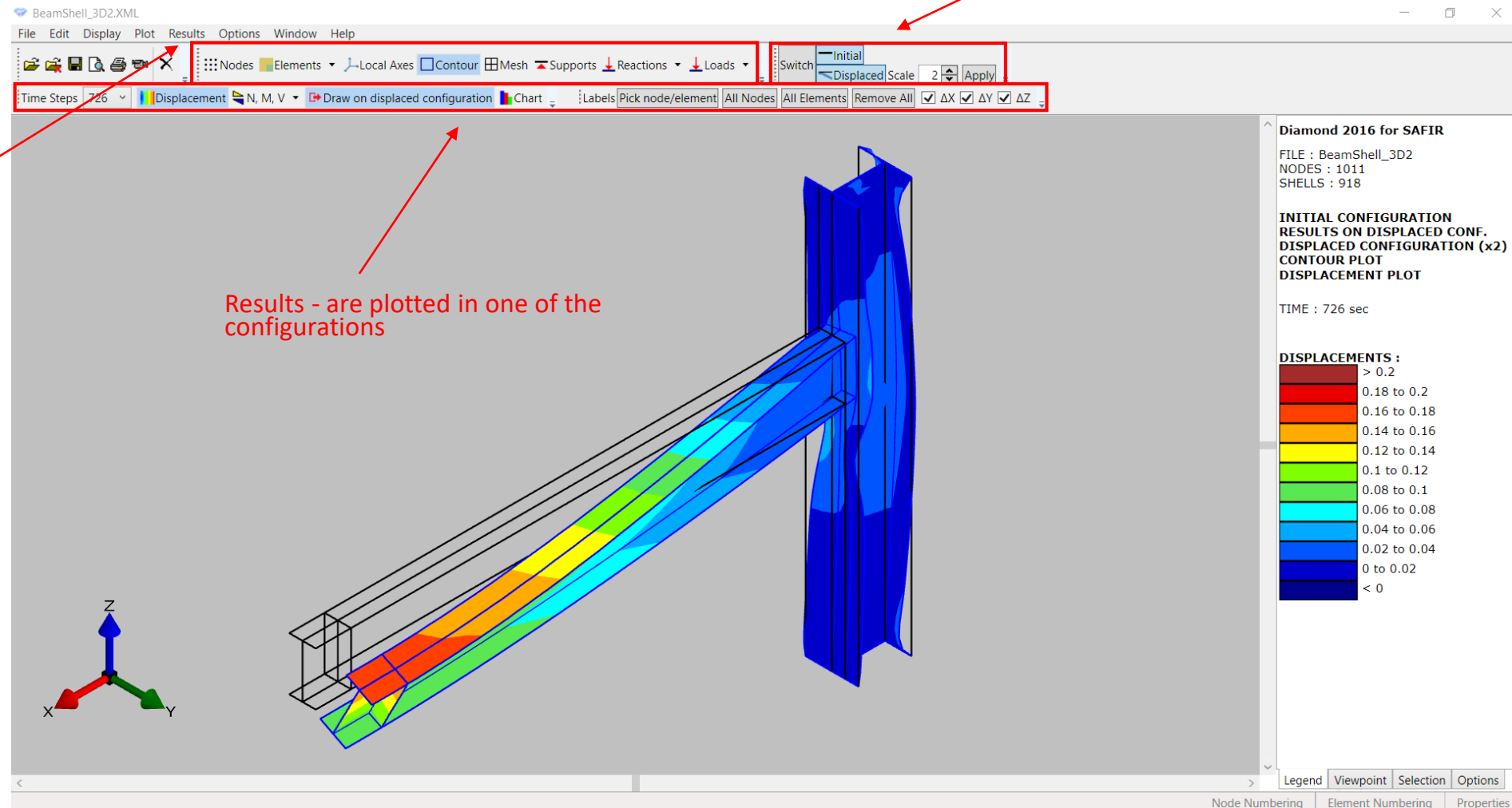

Open file without results

- Allows to quickly check models in big files

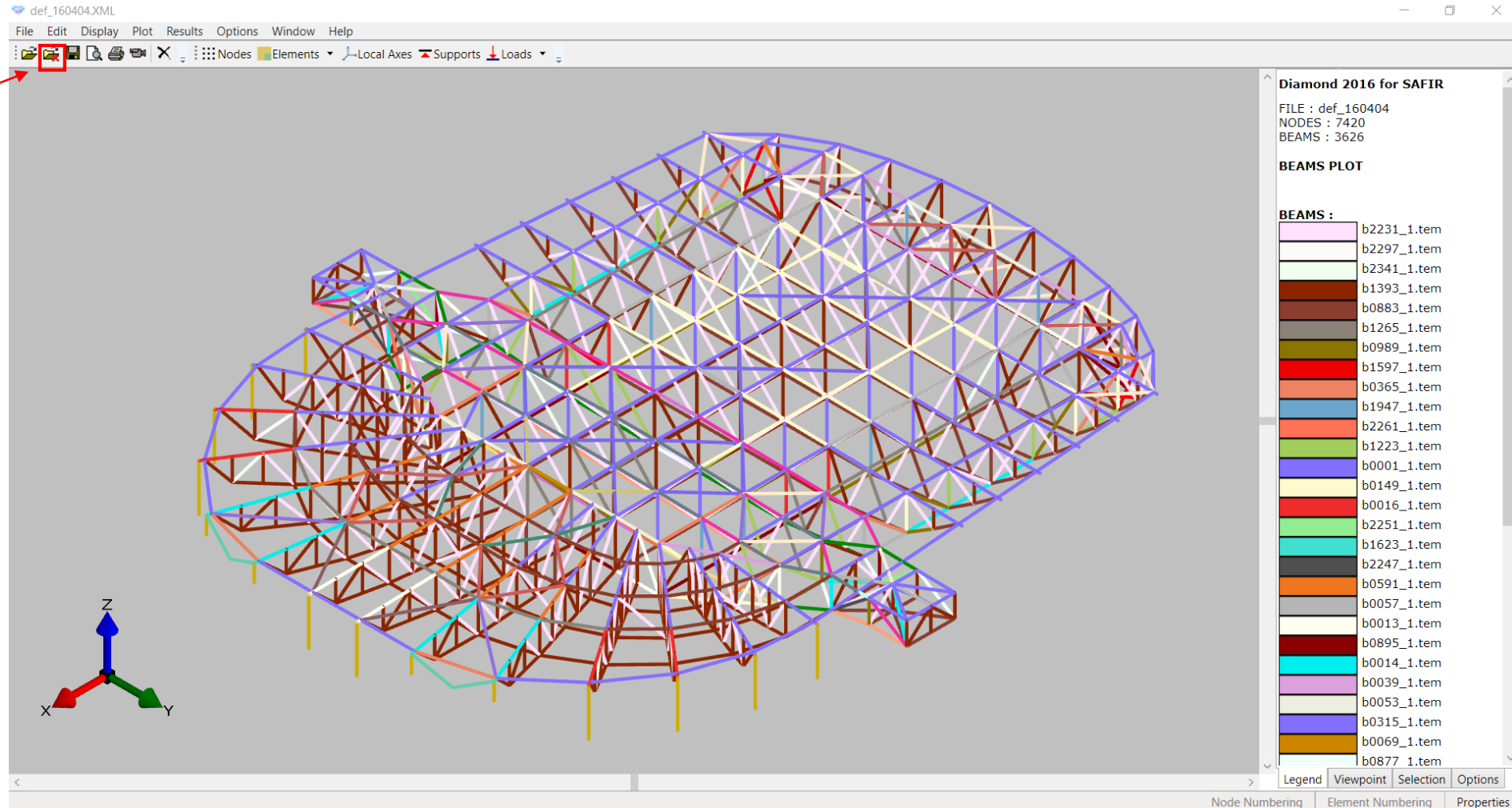

Scale factors

- More clear way of setting the scale factors for loads and forces

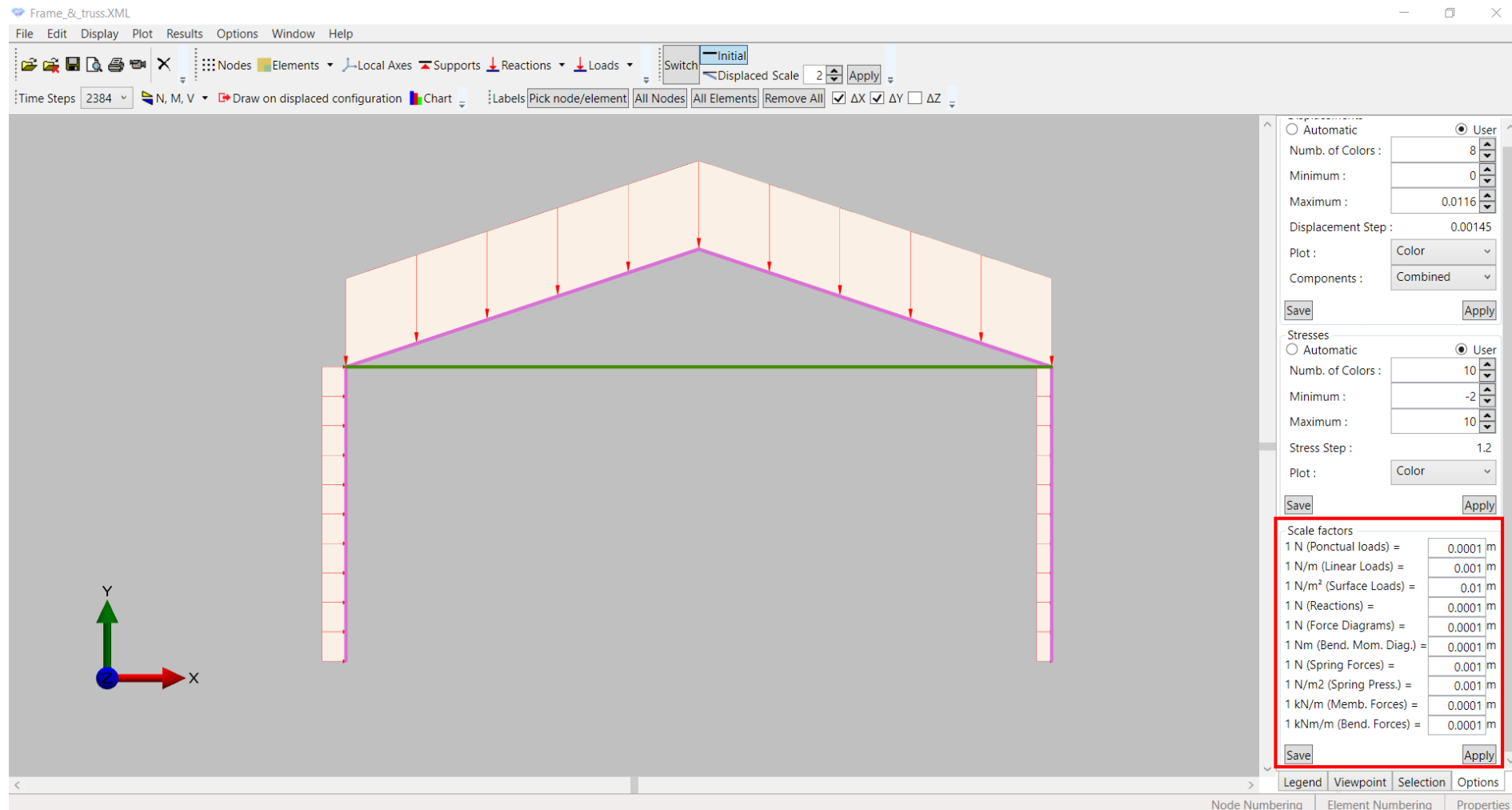

Charts

- Improved user experience with charts

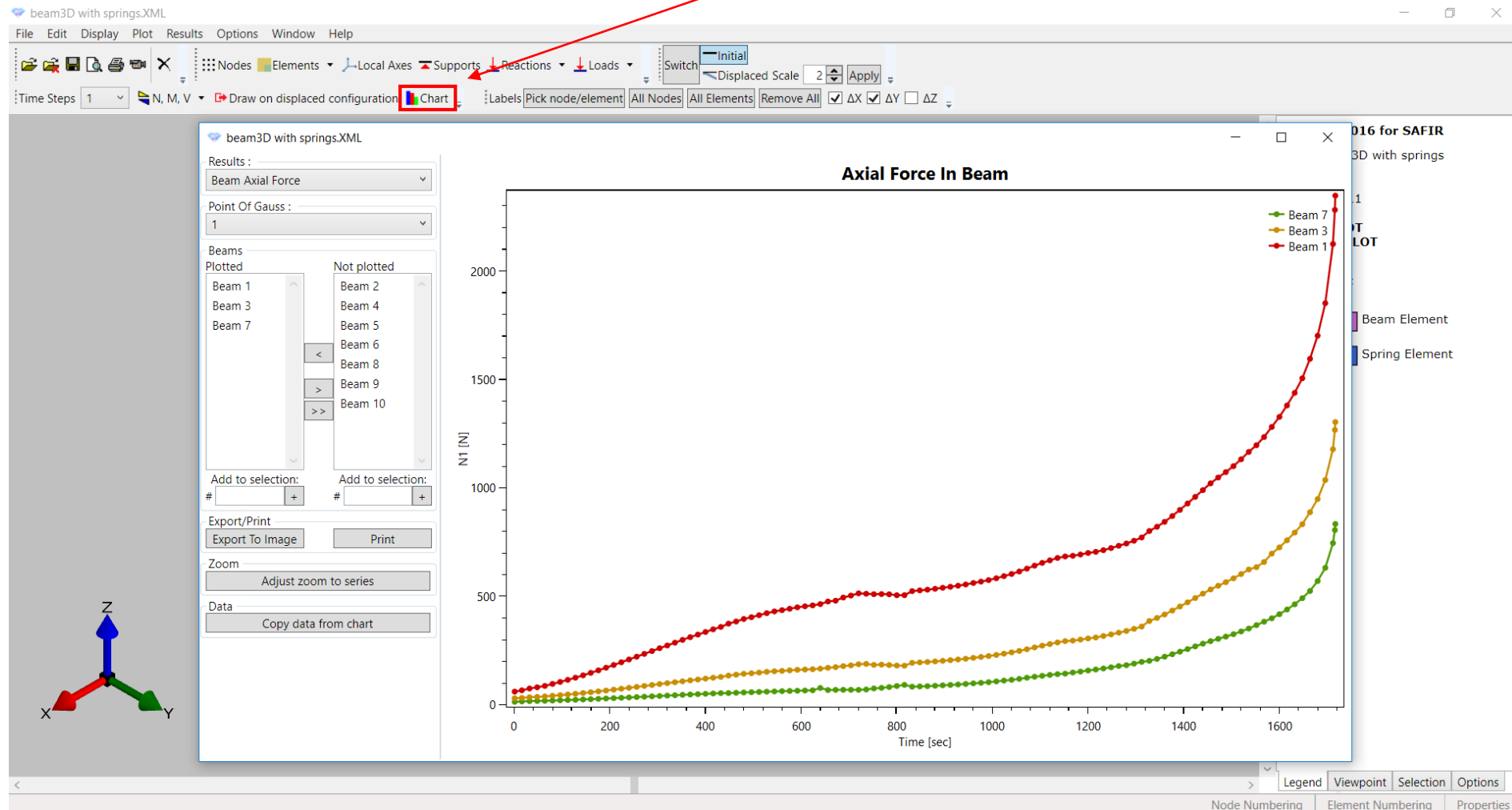

Torsional analysis

- Distribution of the results for the warping function in the cross-section

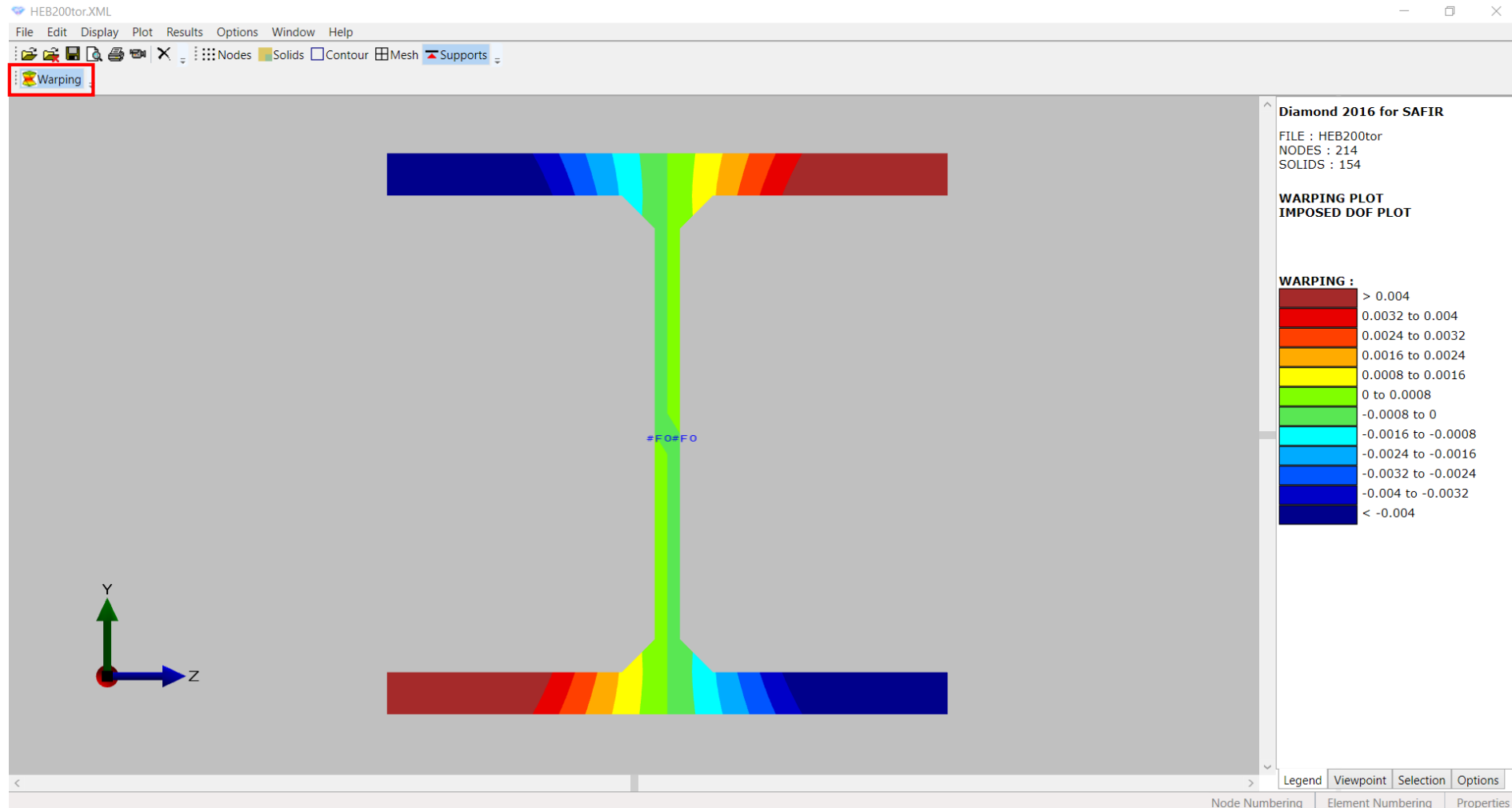

Springs

- Forces and pressures in Springs

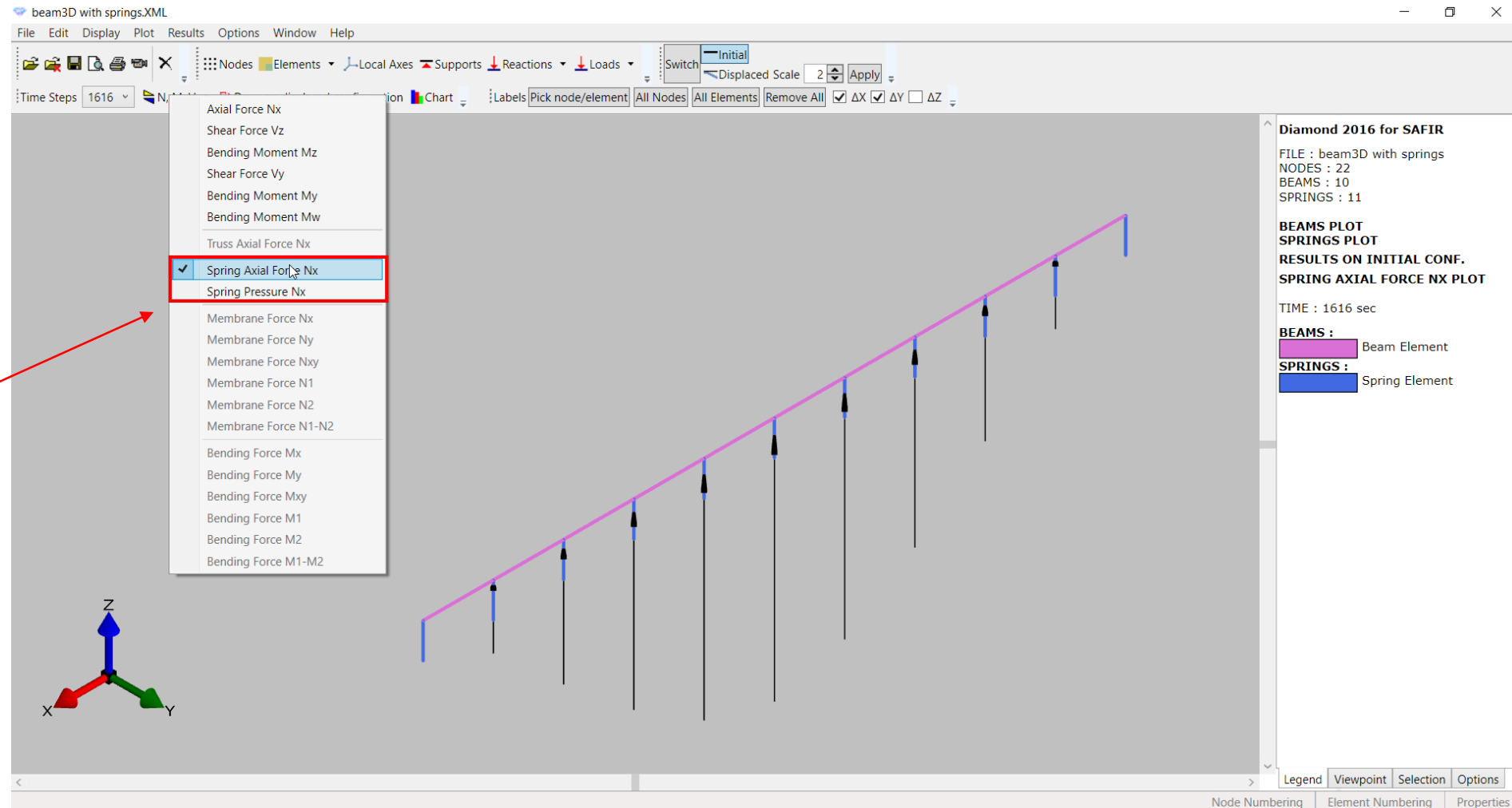

Strains, stresses and tangent modulus

- Strains can now be plotted on the cross-section fibres

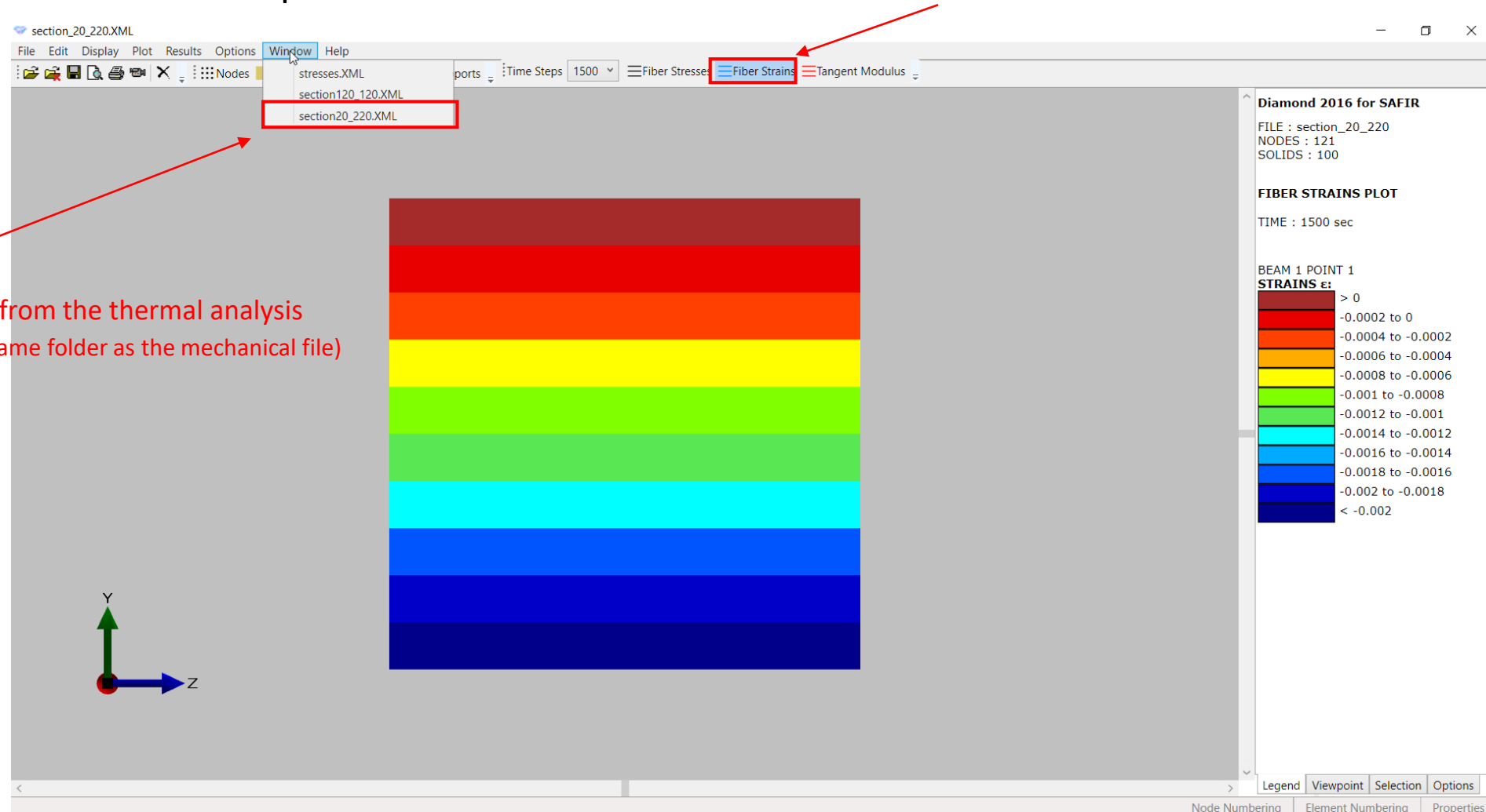

Labels in thermal analyses

- Temperatures

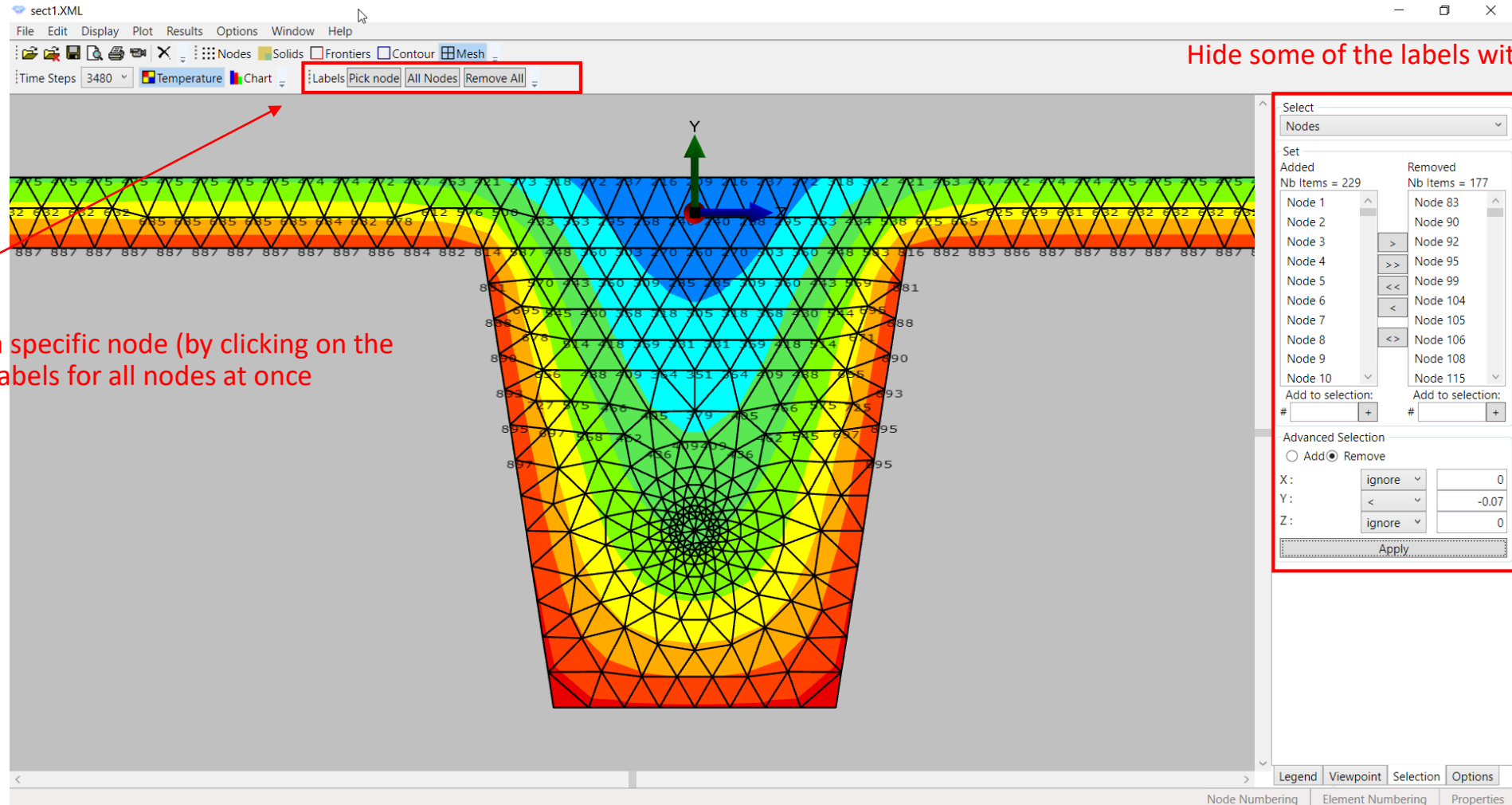

Hide some of the labels with the Selection tool

Add the label for a specific node (by clicking on the node) or add the labels for all nodes at once

Labels in mechanical analyses

- Loads, reactions and forces

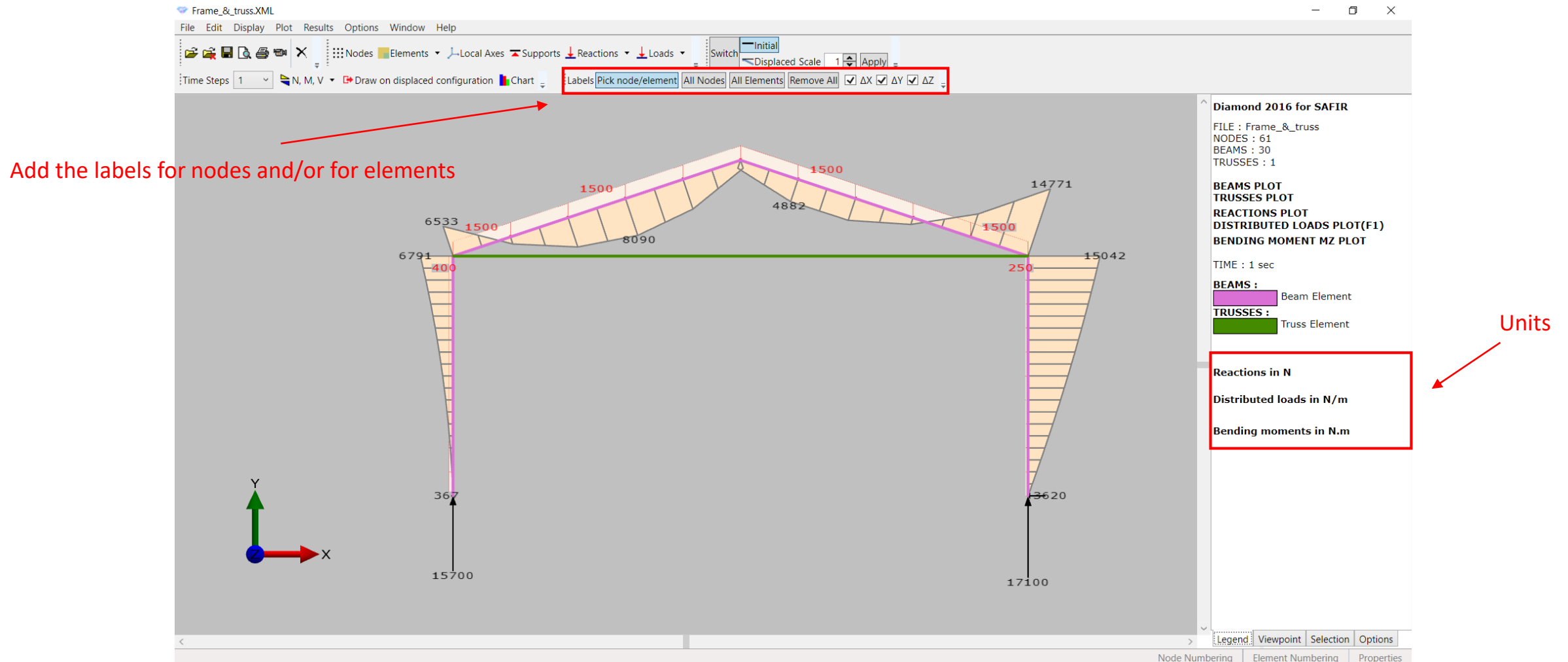

Labels in mechanical analyses

- Displacements

Select the components of the displacements

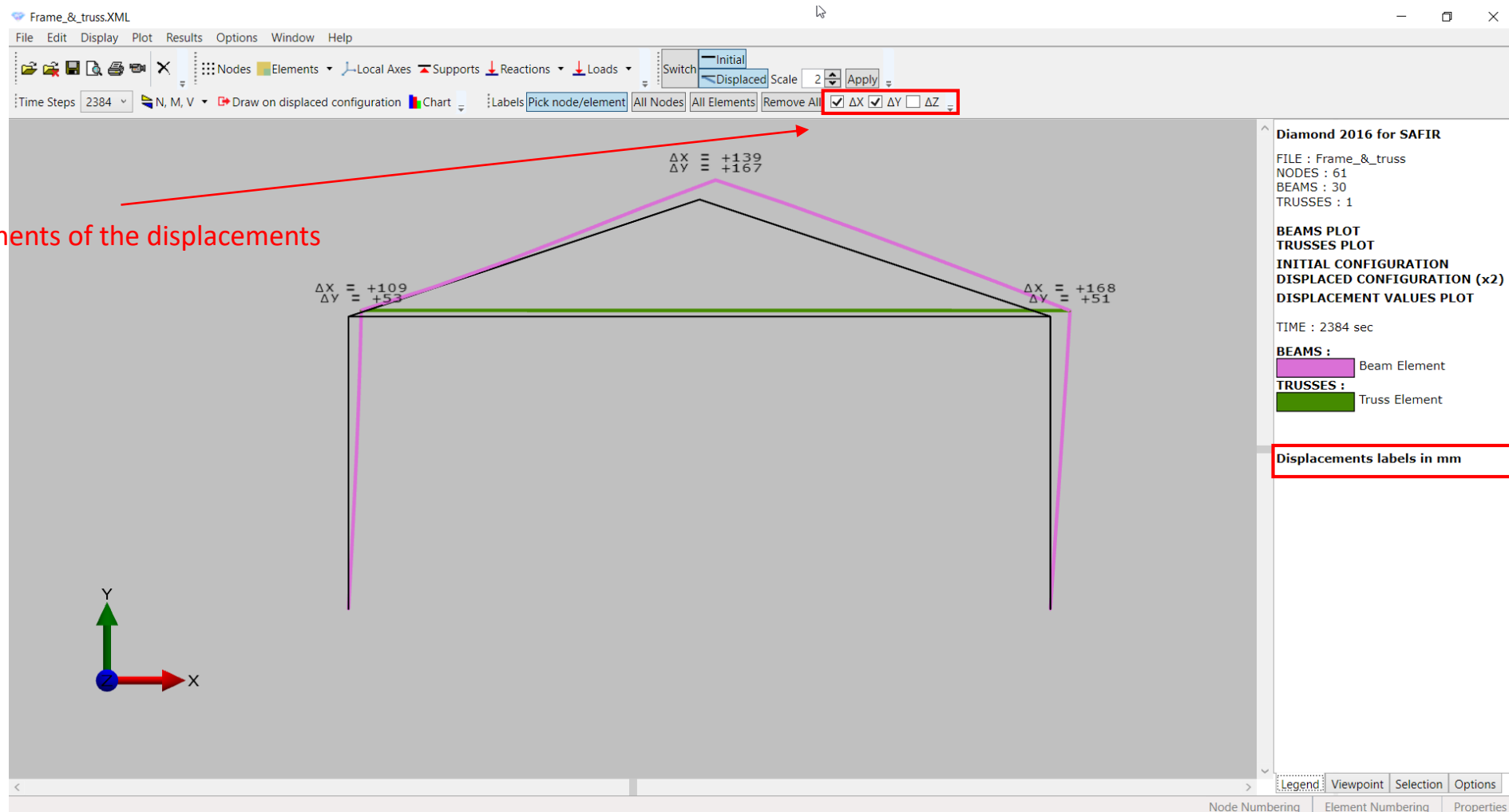

Units

Structural SOLID 3D

- SOLID 3D finite elements available in mechanical analyses

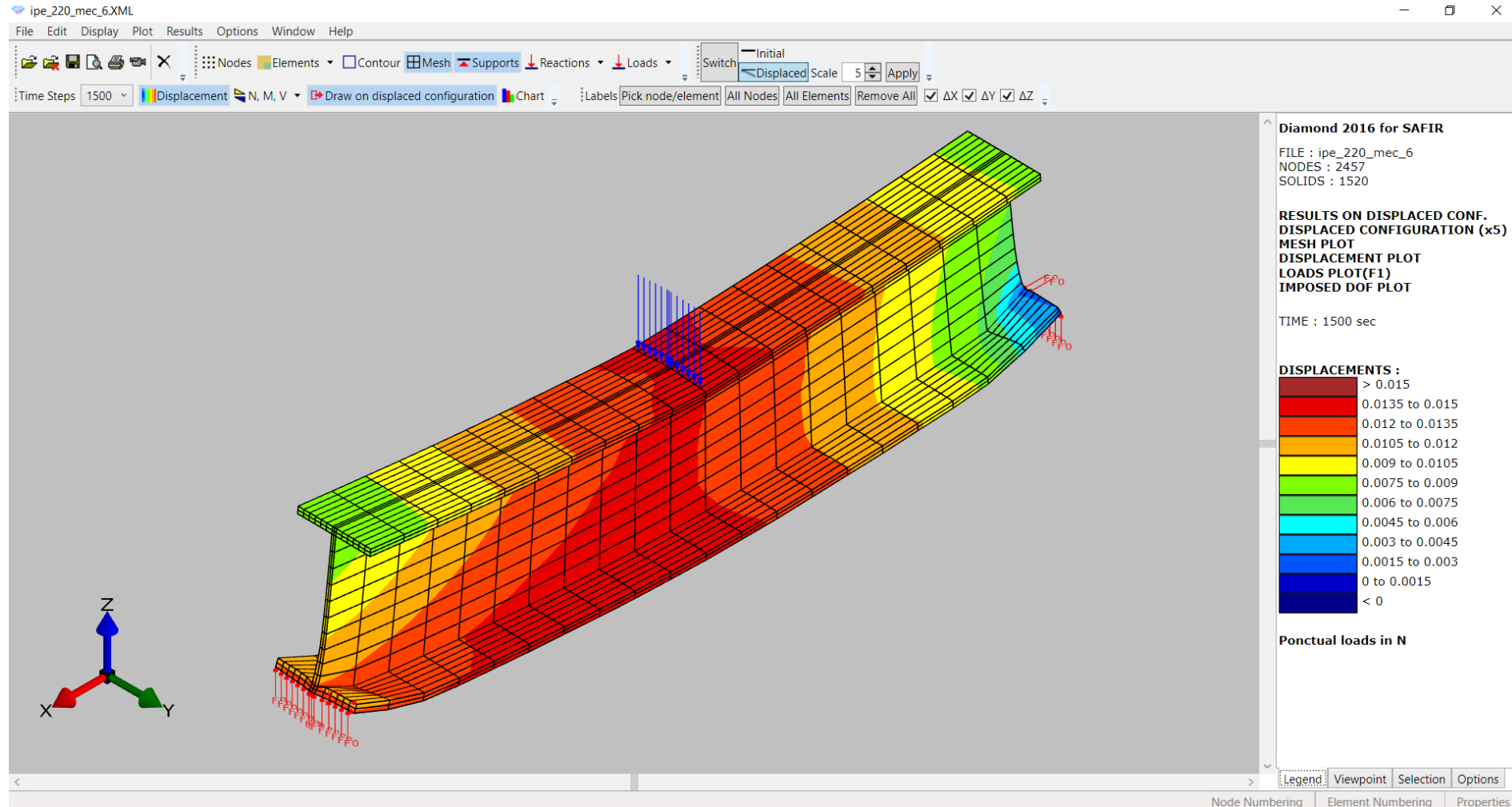

Animation tool

- Time interval for the video animation

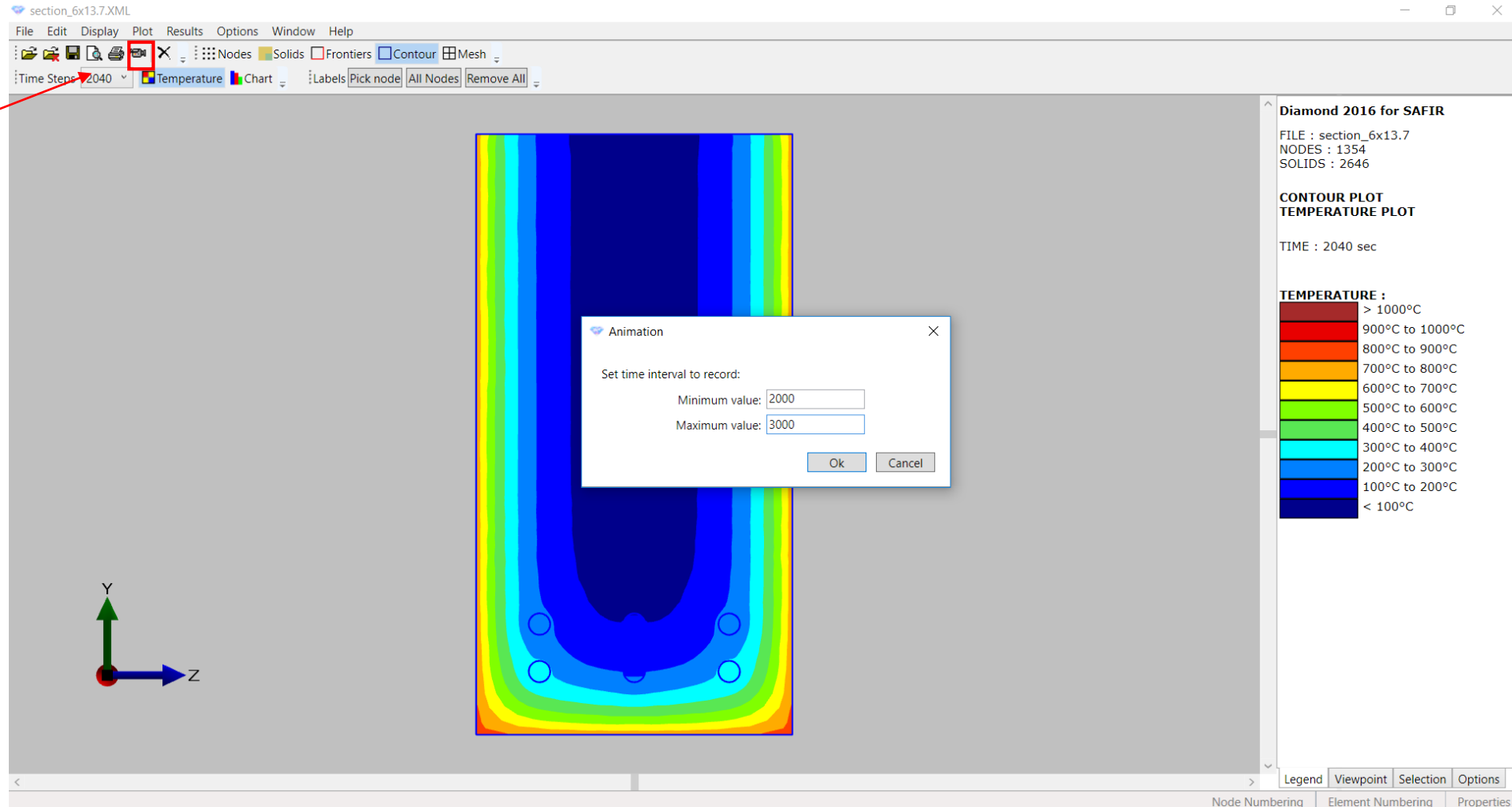

Animation tool

- Time interval for the video animation

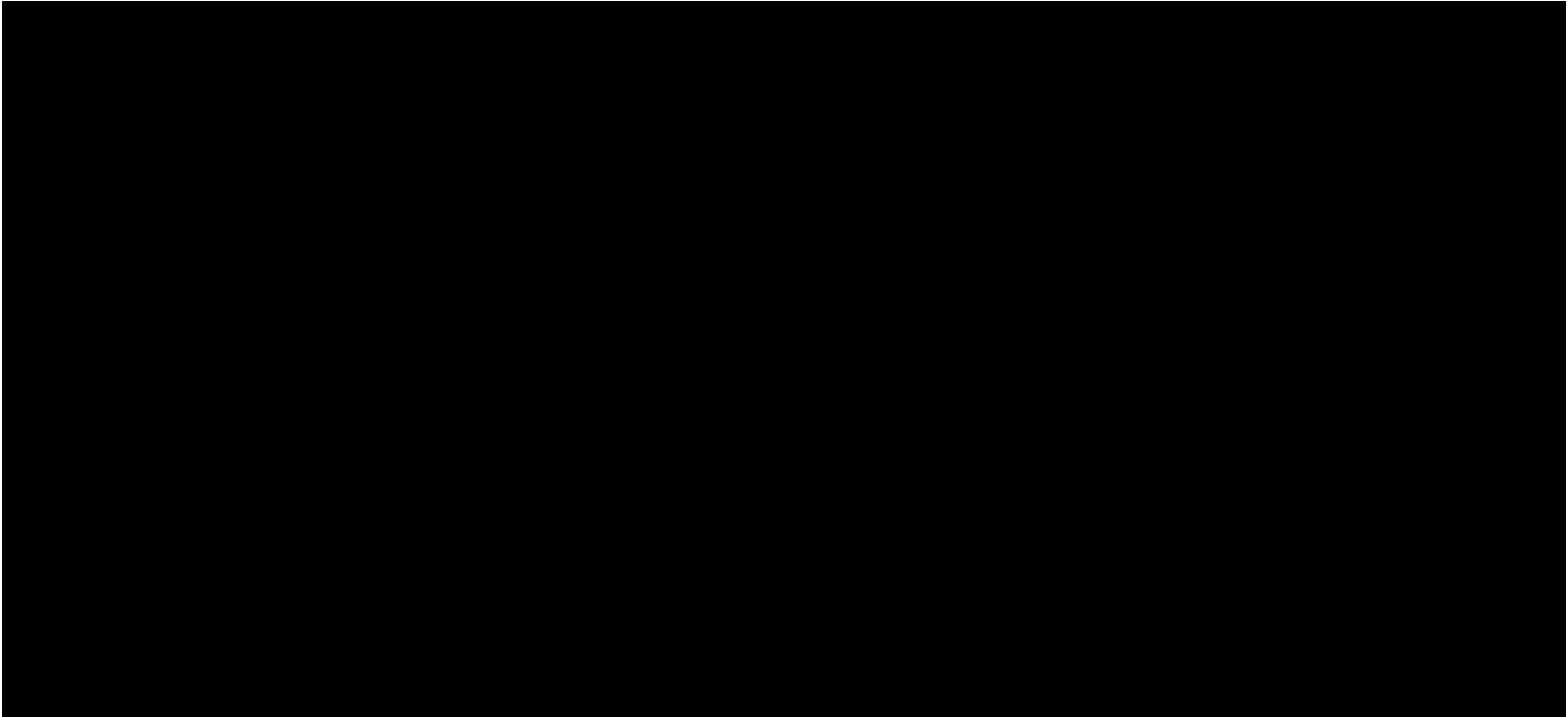

Thank you for you attention

DIAMOND 2016

New features